

W:\14\1832065 - Leighton West Spine Road\08 - Working Files\9994 Lands\CabinetDrawings\BRJ10410-DWG-9994-201.dwg - 31/03/2020 13:35:26 Layout1 - EmeryW

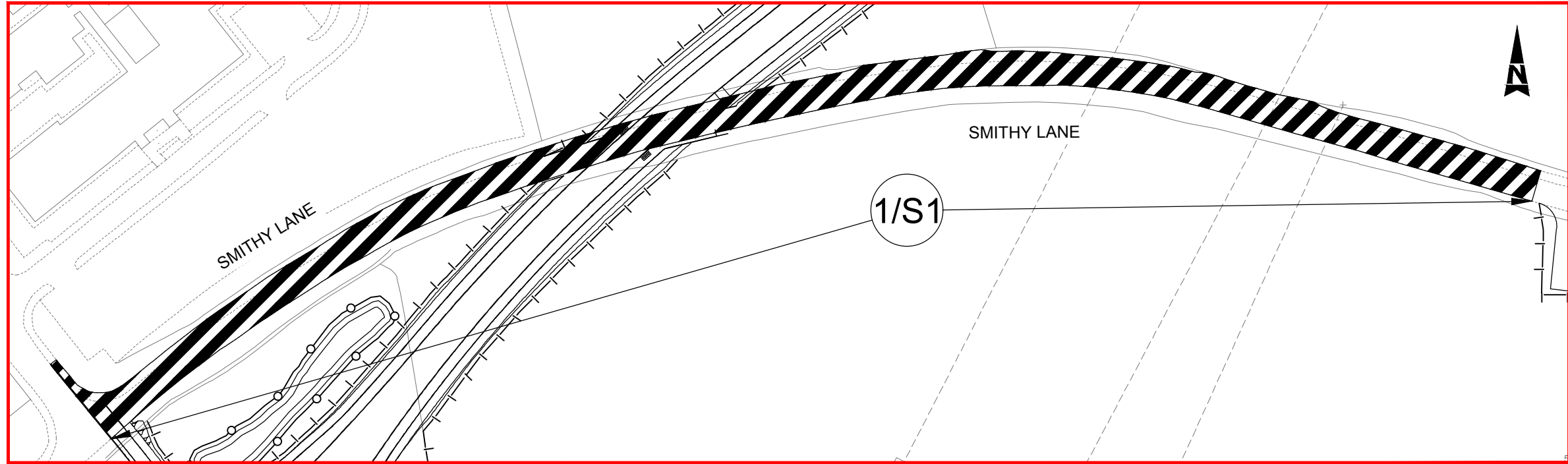

INSET A - 1:1250

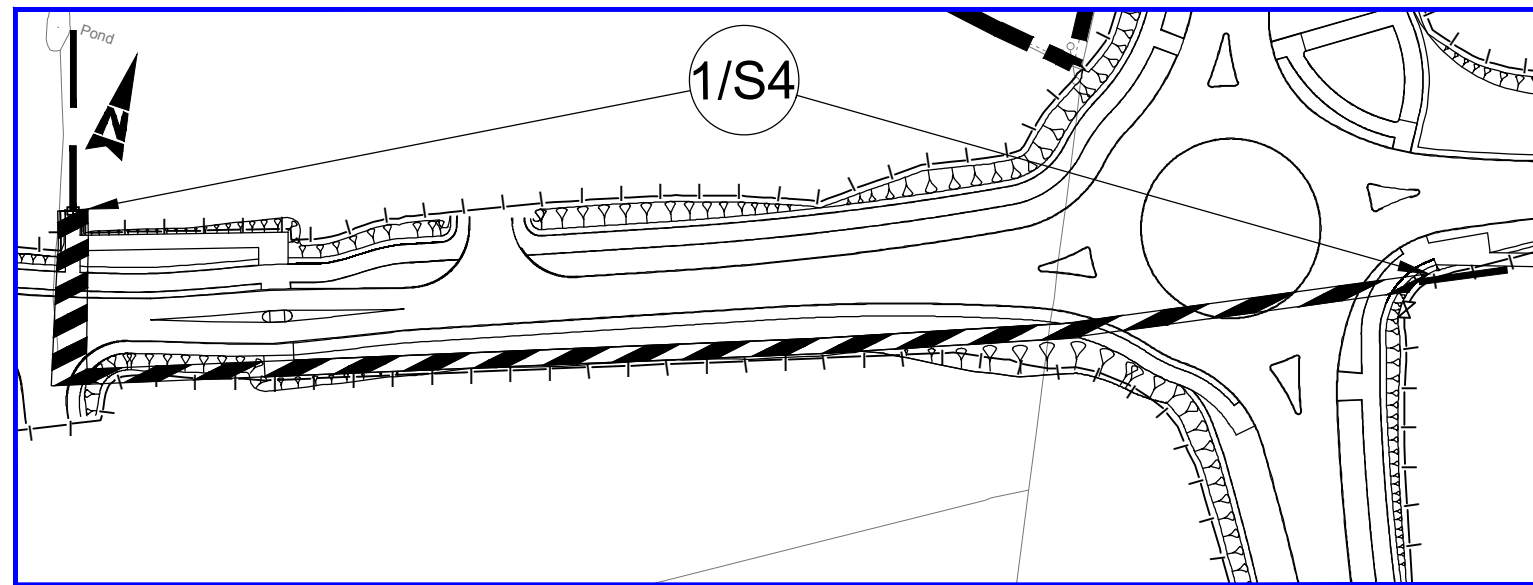

INSET B - 1:1250

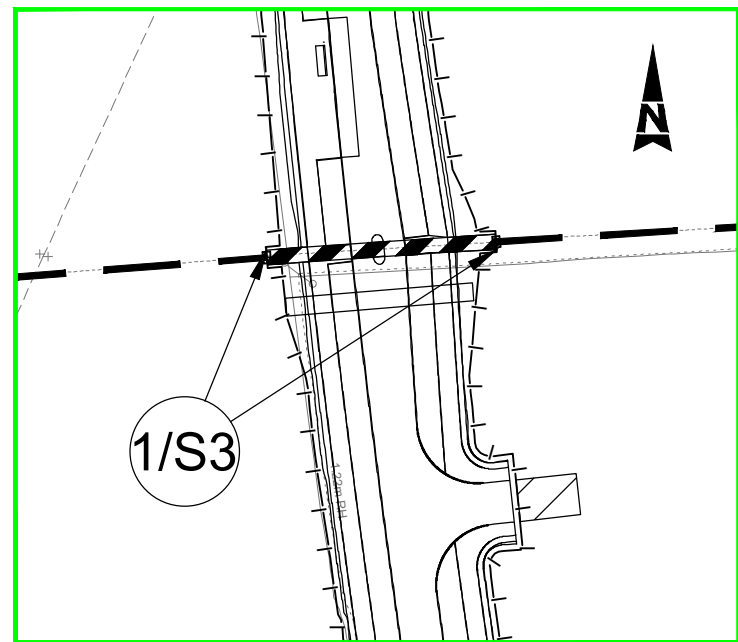

INSET C - 1:1250



INSET D - 1:1250

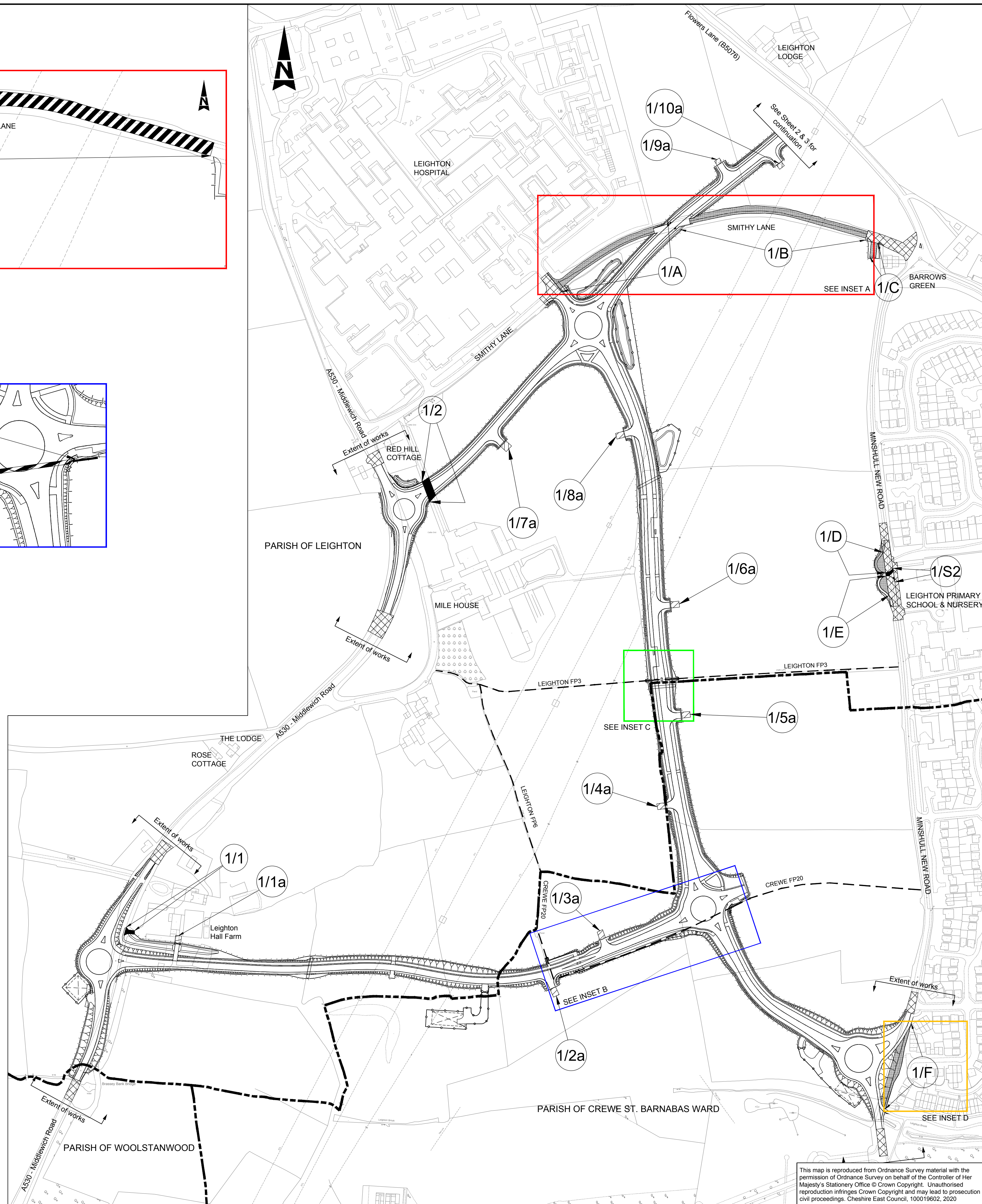

#### Notes

- Order under sections 8, 14 & 125 of the Highway Act 1980.
- This plan does not show widths or construction details.

#### Legend

- New Highway
- Highway to be improved
- Highway to be stopped up
- New private means of access
- Private means of access to be stopped up
- Classified road boundary
- Side road boundary
- Parish boundary
- Public rights of way (labelled)
- 1/1 Private means of access to be stopped up label
- 1/1a New private means of access reference label
- 1/A New side road reference label
- 1/S1 Highway to be stopped up reference label

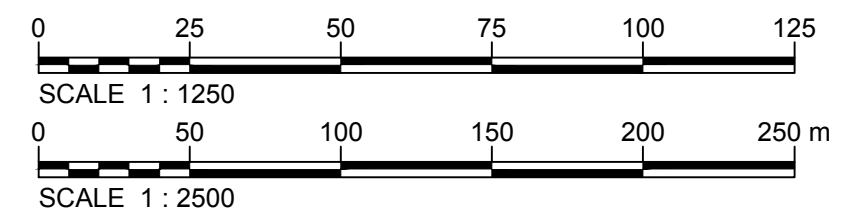

The Common Seal for  
CHESHIRE EAST COUNCIL  
was hereunto affixed  
in the presence of

Dated this                      Day of                      202-

Drawing No. BRJ10410-DWG-9994-201 Revision R0



Project  
**THE CHESHIRE EAST COUNCIL  
(A530 MIDDLEWICH ROAD  
(CLASSIFIED ROAD)) (SIDE ROADS)  
ORDER 2020**

Drawing title  
**SIDE ROAD ORDER  
SITE PLAN 1 OF 4**

This map is reproduced from Ordnance Survey material with the permission of Ordnance Survey on behalf of the Controller of Her Majesty's Stationery Office © Crown Copyright. Unauthorised reproduction infringes Crown Copyright and may lead to prosecution or civil proceedings. Cheshire East Council, 100019602, 2020

© Copyright 2020 Jacobs U.K. Limited. The concepts and information contained in this document are the property of Jacobs. Use or copying of this document in whole or in part without the written permission of Jacobs constitutes an infringement of copyright. Limitation: This drawing has been prepared on behalf of, and for the exclusive use of, Jacobs' Client, and is subject to, and issued in accordance with, the provisions of the contract between Jacobs and the Client. Jacobs accepts no liability or responsibility whatsoever for, or in respect of, any use of, or reliance upon, this drawing by any third party.



M:\HCB\1832065 - Leighton West Spine Road\08 - Working File\9994 Lands\CabinetDrawings\BRJ104 10-DWG-9994-202.dwg - 31/03/2020 13:43:10 - A3Frame - EmeryW

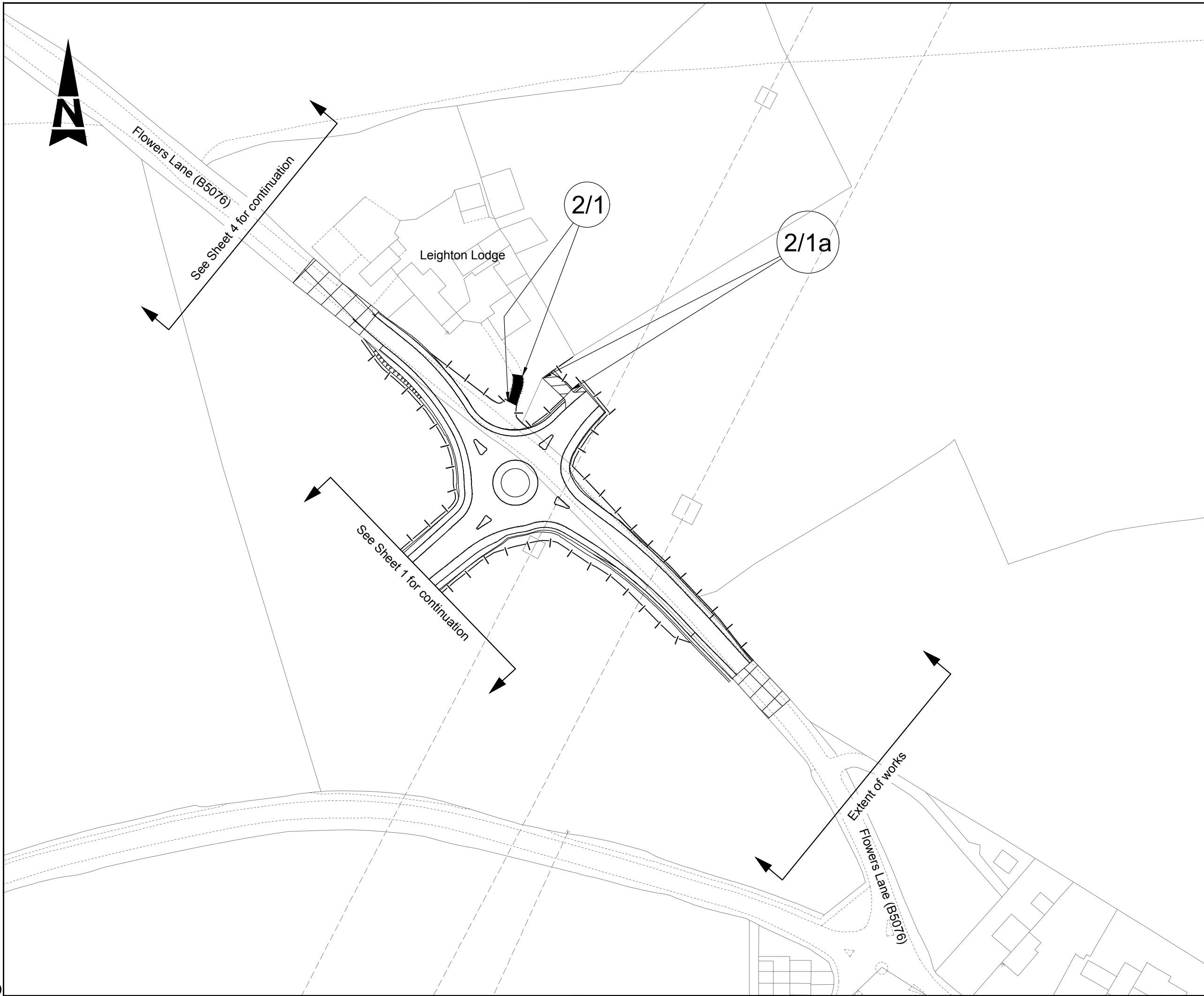

**Notes**

- Order under sections 8, 14 & 125 of the Highway Act 1980.
- This plan does not show widths or construction details.
- Plan drawn to A3 paper size.

**Legend**

	New Highway
	Highway to be improved
	Highway to be stopped up
	New private means of access
	Private means of access to be stopped up
	Classified road boundary
	Side road boundary
	Parish boundary
	Public rights of way (labelled)
	Private means of access to be stopped up label
	New private means of access reference label
	New side road reference label
	Highway to be stopped up reference label

0 25 50 75 100 125  
SCALE 1 : 1250

0 50 100 150 200 250 m  
SCALE 1 : 2500

The Common Seal for  
CHESHIRE EAST COUNCIL  
was hereunto affixed  
in the presence of

Dated this                      Day of                      202-

Drawing No.	BRJ104 10-DWG-9994-202	Revision	R0
-------------	------------------------	----------	----

Project

The Cheshire East Council  
(B5076 Flowers Lane Classified Road  
Fairfield Roundabout A) (Side Roads)  
Order 2020

Drawing title

SIDE ROAD ORDER  
SITE PLAN 2 OF 4

© Copyright 2020 Jacobs U.K. Limited. The concepts and information contained in this document are the property of Jacobs. Use or copying of this document in whole or in part without the written permission of Jacobs constitutes an infringement of copyright. Limitation. This drawing has been prepared on behalf of, and for the exclusive use of Jacobs' Client, and is subject to, and issued in accordance with, the provisions of the contract between Jacobs and the Client. Jacobs accepts no liability or responsibility whatsoever for, or in respect of, any use of, or reliance upon, this drawing by any third party.

M:\HCB\1820265 - Leighton West Spine Road\08 - Working File\9994 Lands\CabinetDrawings\BRJ104 10-DWG-9994-203.dwg - 30/03/2020 14:48:38 - A3Frame - EmeryW

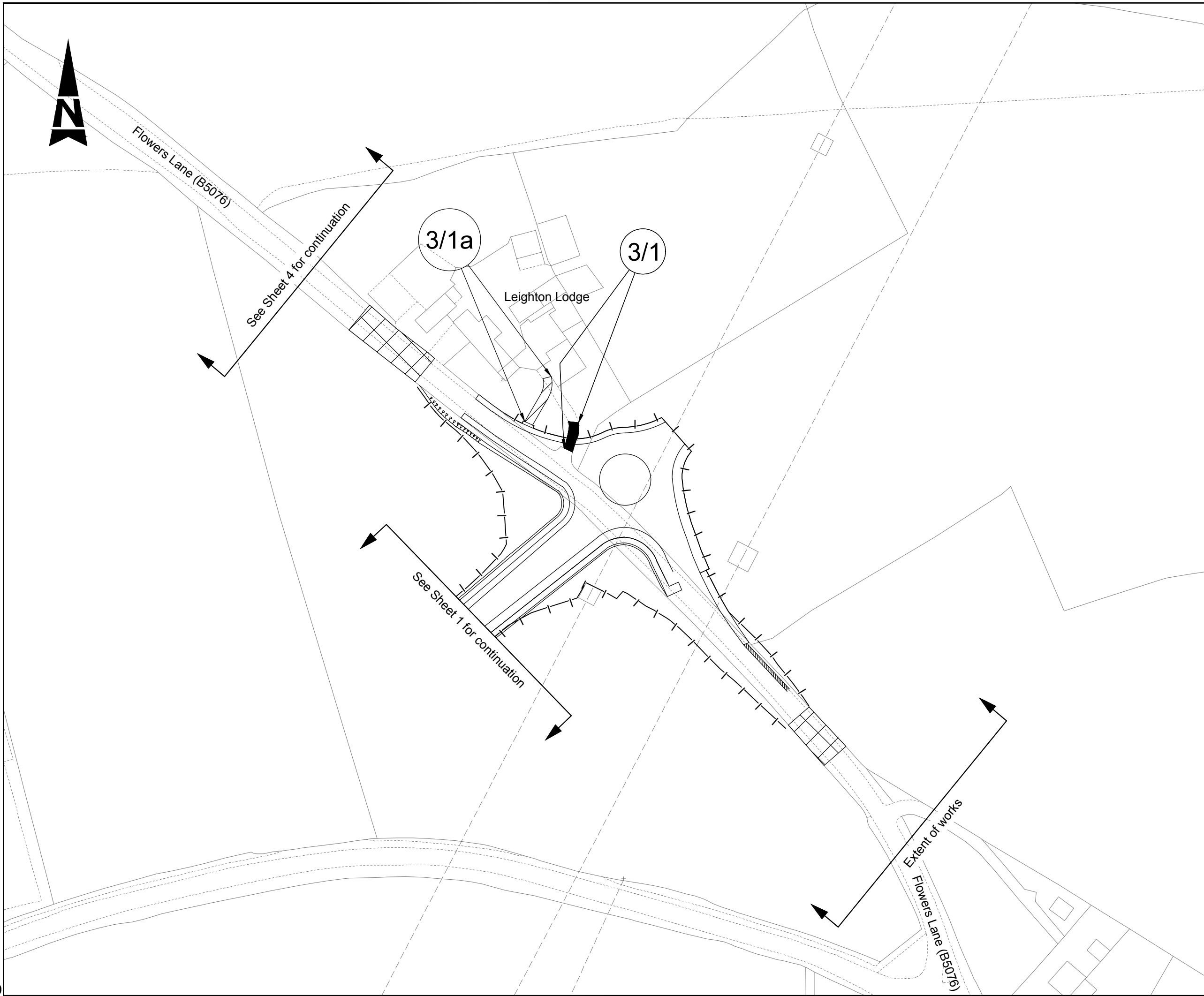

**Notes**

- Order under sections 8, 14 & 125 of the Highway Act 1980.
- This plan does not show widths or construction details.
- Plan drawn to A3 paper size.

**Legend**

	New Highway
	Highway to be improved
	Highway to be stopped up
	New private means of access
	Private means of access to be stopped up
	Classified road boundary
	Side road boundary
	Parish boundary
	Public rights of way (labelled)
	Private means of access to be stopped up label
	New private means of access reference label
	New side road reference label
	Highway to be stopped up reference label

0 25 50 75 100 125  
SCALE 1 : 1250

0 50 100 150 200 250 m  
SCALE 1 : 2500

The Common Seal for  
CHESHIRE EAST COUNCIL  
was hereunto affixed  
in the presence of

Dated this                      Day of                      202-

Drawing No.	BRJ104 10-DWG-9994-203	Revision	R0
-------------	------------------------	----------	----

Project

The Cheshire East Council  
(B5076 Flowers Lane Classified Road  
Fairfield Roundabout B) (Side Roads)  
Order 2020

Drawing title

**SIDE ROAD ORDER  
SITE PLAN 3 OF 4**

© Copyright 2020 Jacobs U.K. Limited. The concepts and information contained in this document are the property of Jacobs. Use or copying of this document in whole or in part without the written permission of Jacobs constitutes an infringement of copyright. Limitation. This drawing has been prepared on behalf of, and for the exclusive use of, Jacobs' Client, and is subject to, and issued in accordance with, the provisions of the contract between Jacobs and the Client. Jacobs accepts no liability or responsibility whatsoever for, or in respect of, any use of, or reliance upon, this drawing by any third party.

M:\HCB\1832065 - Leighton West Spine Road\08 - Working File\994 Land\Drawings\BRJ104-10-DWG-994-204.dwg - 30/03/2020 14:50:35 - A3Frame - EmeryW

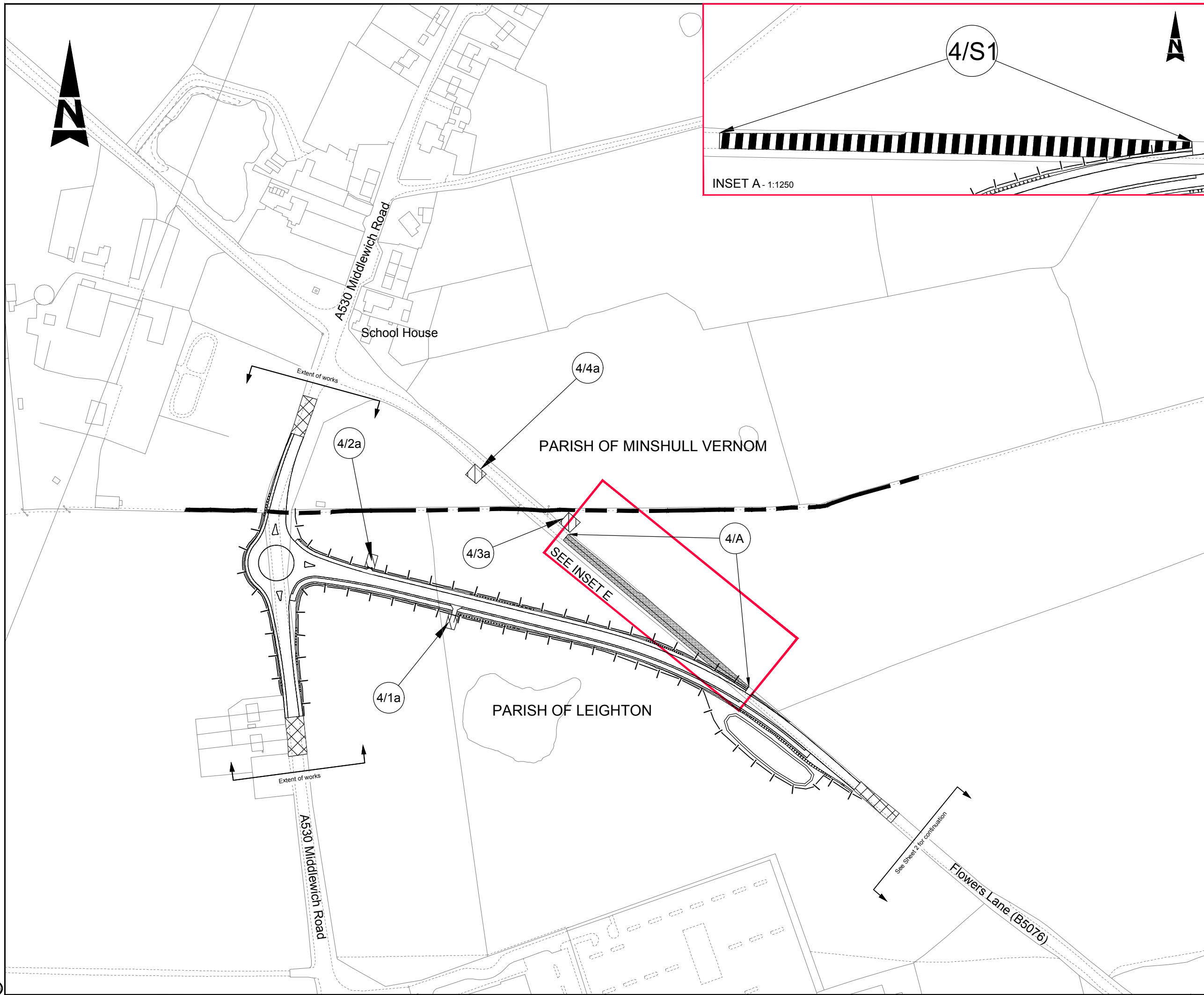

INSET A - 1:1250

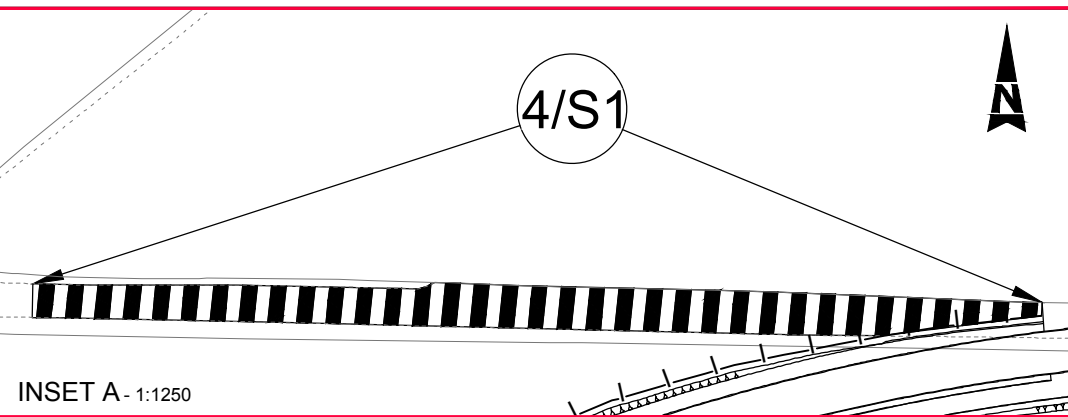

**Notes**

- Order under sections 8, 14 & 125 of the Highway Act 1980.
- This plan does not show widths or construction details.
- Plan drawn to A3 paper size.

**Legend**

	New Highway
	Highway to be improved
	Highway to be stopped up
	New private means of access
	Private means of access to be stopped up
	Classified road boundary
	Side road boundary
	Parish boundary
	Public rights of way (labelled)
	Private means of access to be stopped up label
	New private means of access reference label
	New side road reference label
	Highway to be stopped up reference label

SCALE 1 : 1250

SCALE 1 : 2500

The Common Seal for  
CHESHIRE EAST COUNCIL  
was hereunto affixed  
in the presence of

Dated this                      Day of                      202-

Drawing No.	BRJ10410-DWG-994-204	Revision	R0
-------------	----------------------	----------	----

Project

The Cheshire East Council  
(B5076 Flowers Lane  
Classified Road) (Side Roads)  
Order 2020

Drawing title

**SIDE ROAD ORDER  
SITE PLAN 4 OF 4**

© Copyright 2020 Jacobs U.K. Limited. The concepts and information contained in this document are the property of Jacobs. Use or copying of this document in whole or in part without the written permission of Jacobs constitutes an infringement of copyright. Limitation: This drawing has been prepared on behalf of, and for the exclusive use of Jacobs' Client, and is subject to, and issued in accordance with, the provisions of the contract between Jacobs and the Client. Jacobs accepts no liability or responsibility whatsoever for, or in respect of, any use of, or reliance upon, this drawing by any third party.