

Reproduced by permission of Ordnance Survey on behalf of HMSO. © Crown copyright and database right 2020. All rights reserved. Ordnance Survey Licence number 100049045 2020.

0 10 20 30 40 50 m  
SCALE 1:1,000 @ A1

- NOTES:**
- Order under sections 8, 239, 240, 246, 250 and 260 of the Highways Act 1980.
  - This plan does not show widths or construction details.

**KEY**

	Title
	S250 Right
	Local authority boundary
	Parish boundary
	Public right of way
0038	Ordnance Survey field numbers

The Common Seal of  
CHESHIRE EAST BOROUGH COUNCIL  
was hereunto affixed in the presence of

Dated this                      day of                      2020

Drawing No.	BRJ10412-CPO-001	Revision	0
-------------	------------------	----------	---

CHESHIRE EAST BOROUGH COUNCIL (A500 DUALLING) COMPULSORY PURCHASE ORDER PLAN 2020	MEREMOOR MOSS ROUNDBOUT AND OTHER ALTERATIONS SITE PLAN NO.1
--	---



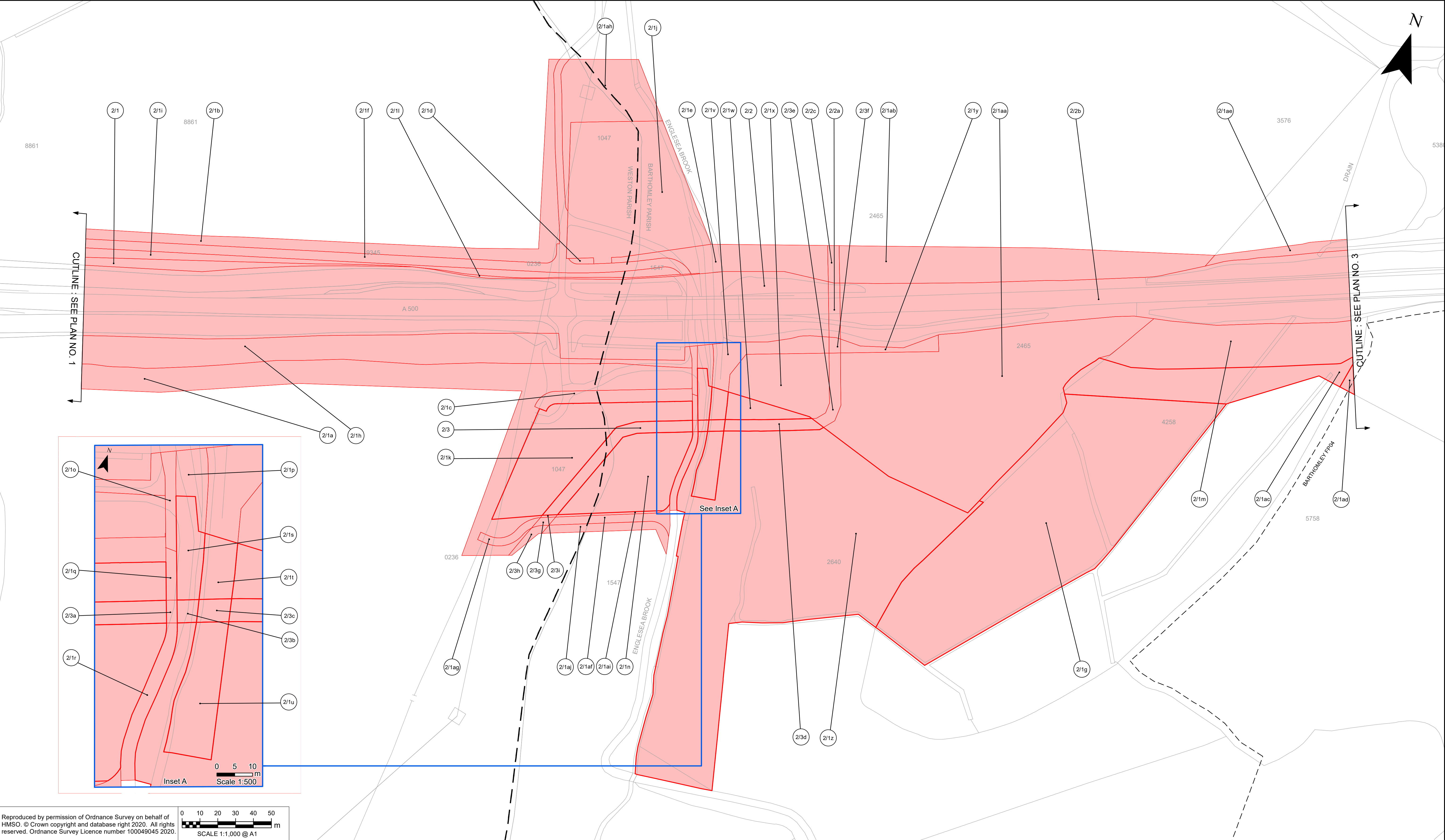

Reproduced by permission of Ordnance Survey on behalf of HMSO. © Crown copyright and database right 2020. All rights reserved. Ordnance Survey Licence number 100049045 2020.

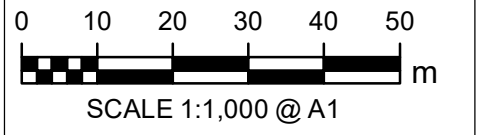

**NOTES:**

1. Order under sections 8, 239, 240, 246, 250 and 260 of the Highways Act 1980.
2. This plan does not show widths or construction details.

**KEY**

- Title
- S250 Right
- Local authority boundary
- Parish boundary
- Public right of way
- 0038 Ordnance Survey field numbers

The Common Seal of  
CHESHIRE EAST BOROUGH COUNCIL  
was hereunto affixed in the presence of

Dated this                      day of                      2020



Drawing No. BRJ10412-CPO-002      Revision      0

CHESHIRE EAST BOROUGH COUNCIL  
(A500 DUALLING)  
COMPULSORY PURCHASE ORDER  
PLAN 2020

ENGLESEA BROOK,  
THE DUCKERIES  
AND OTHER ALTERATIONS  
SITE PLAN NO. 2



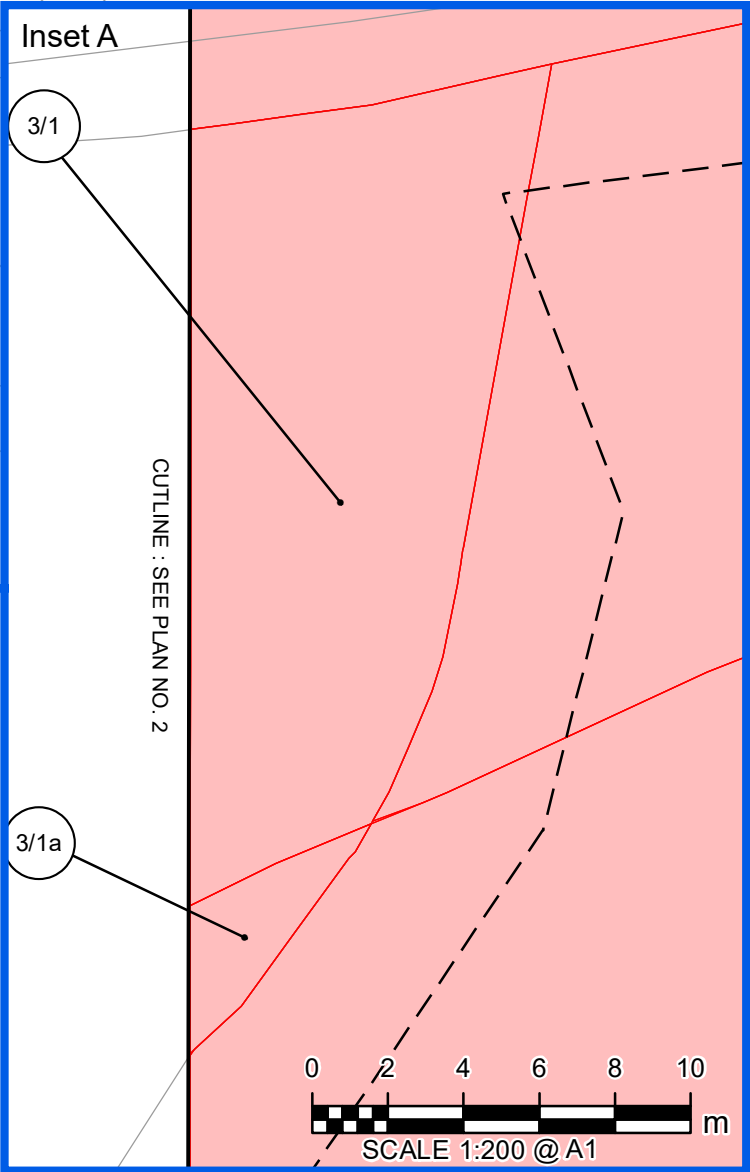
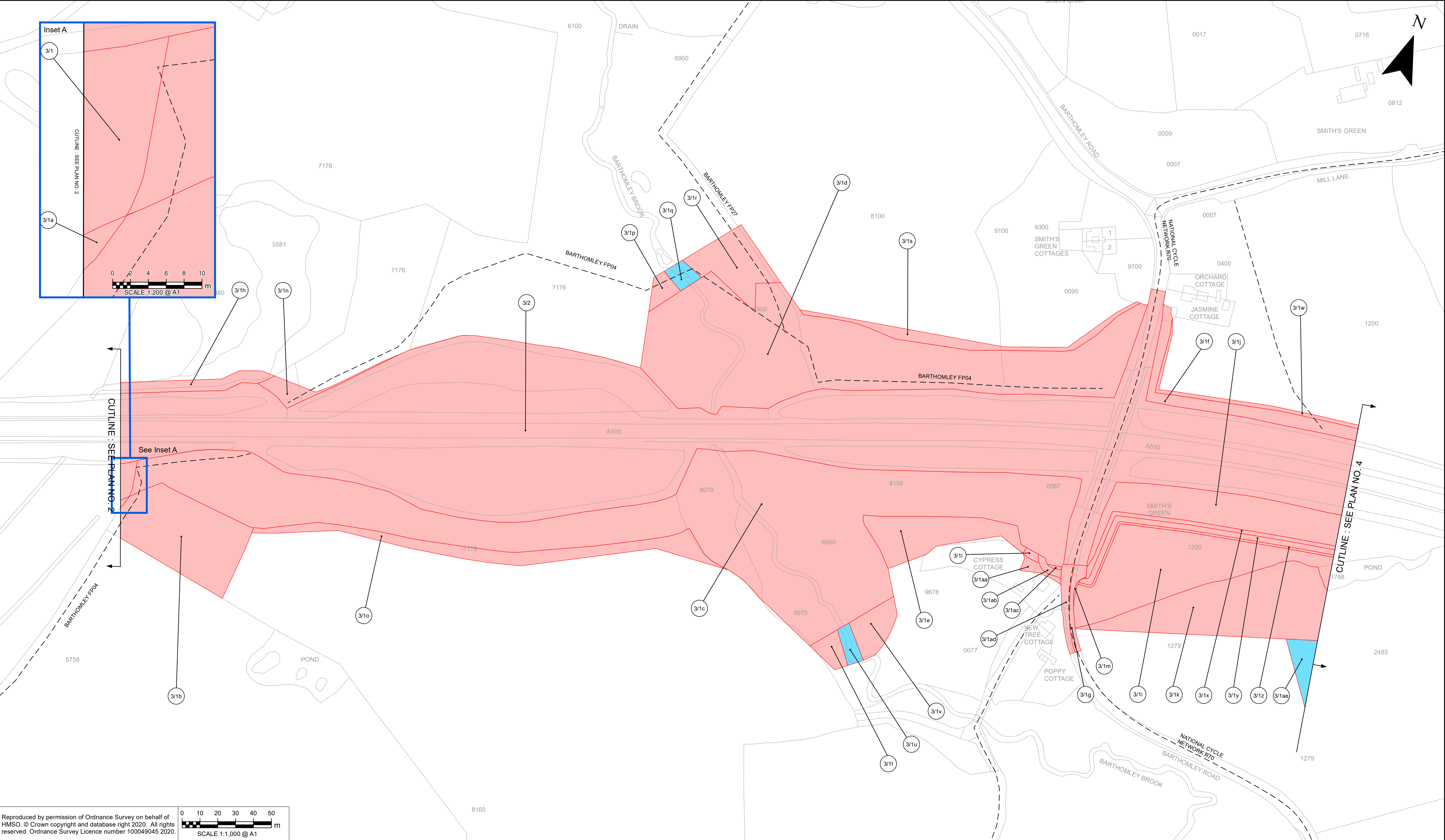

Reproduced by permission of Ordnance Survey on behalf of HMSO. © Crown copyright and database right 2020. All rights reserved. Ordnance Survey Licence number 100049045 2020.

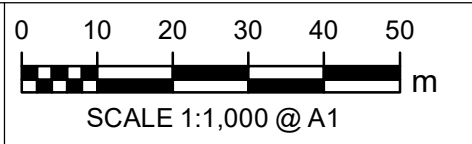

**NOTES:**

- Order under sections 8, 239, 240, 246, 250 and 260 of the Highways Act 1980.
- This plan does not show widths or construction details.

**KEY**

- Title
- S250 Right
- Local authority boundary
- Parish boundary
- Public right of way
- 0038 Ordnance Survey field numbers

The Common Seal of  
CHESHIRE EAST BOROUGH COUNCIL  
was hereunto affixed in the presence of

Dated this                      day of                      2020



Drawing No. BRJ10412-CPO-003      Revision      0

CHESHIRE EAST BOROUGH COUNCIL  
(A500 DUALLING)  
COMPULSORY PURCHASE ORDER  
PLAN 2020

BARTHOMLEY BROOK,  
BARTHOMLEY ROAD AND  
OTHER ALTERATIONS  
SITE PLAN NO. 3



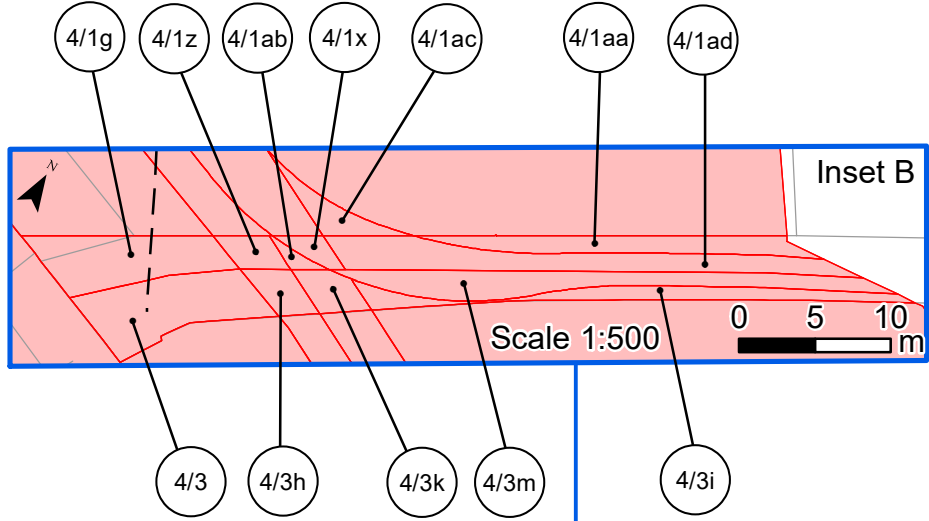
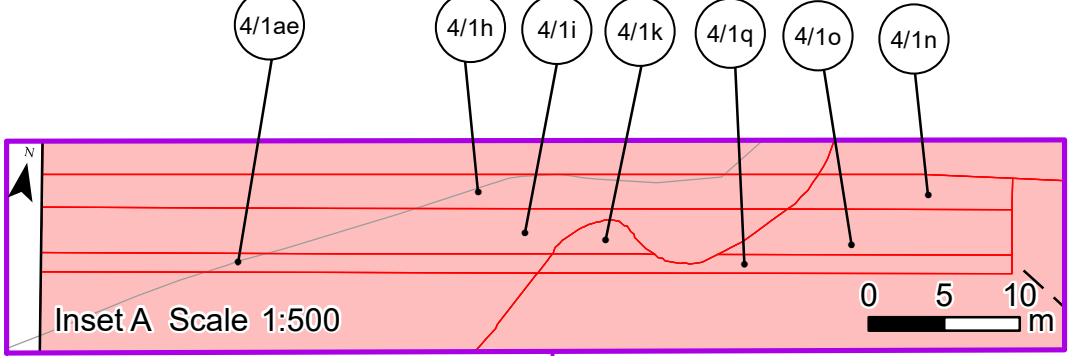
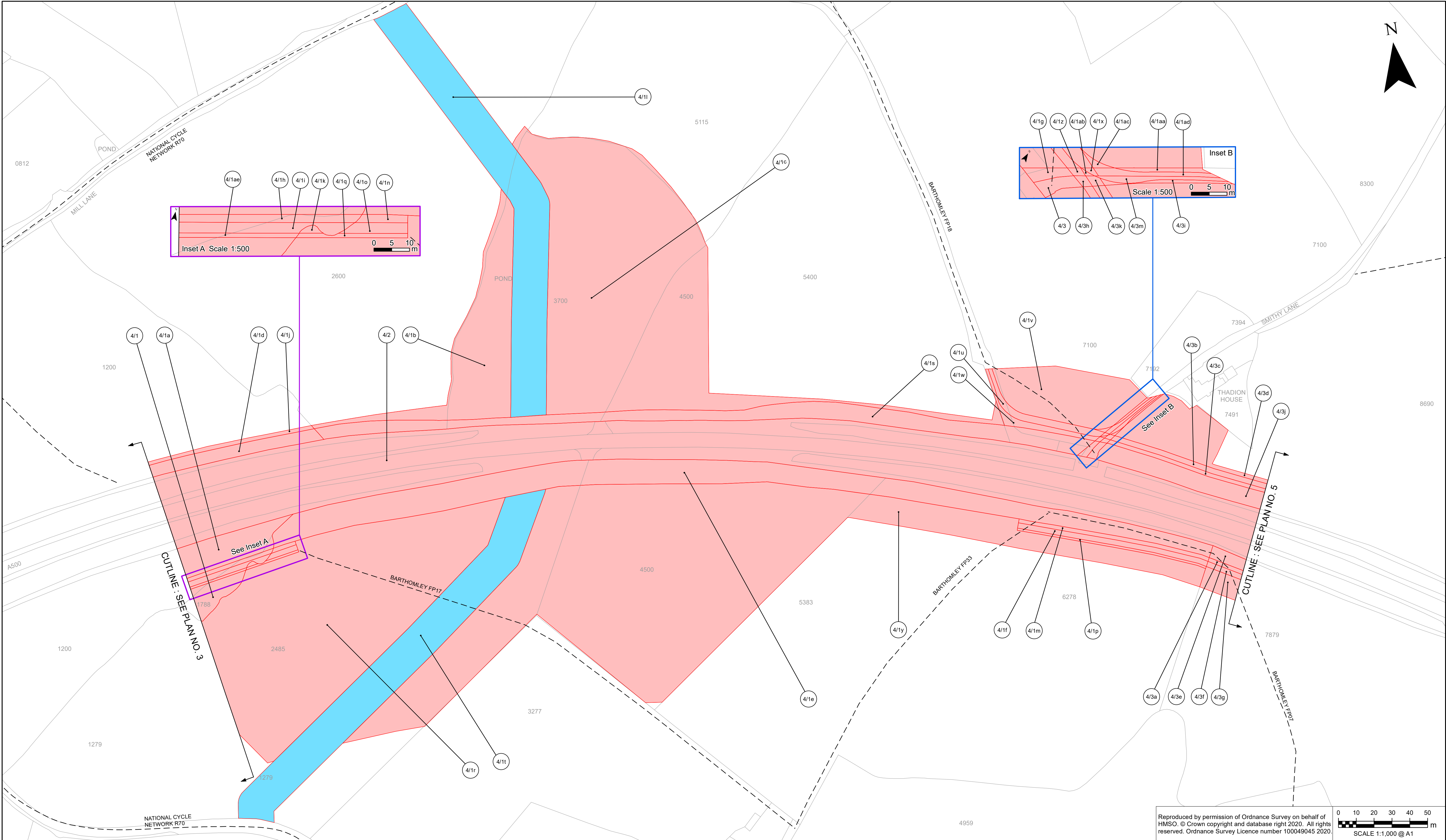

- NOTES:**
- Order under sections 8, 239, 240, 246, 250 and 260 of the Highways Act 1980.
  - This plan does not show widths or construction details.

- KEY**
- Title
  - S250 Right
  - Local authority boundary
  - Parish boundary
  - Public right of way
  - 0038 Ordnance Survey field numbers

The Common Seal of  
CHESHIRE EAST BOROUGH COUNCIL  
was hereunto affixed in the presence of

Dated this                      day of                      2020



Drawing No. BRJ10412-CPO-004      Revision      6

CHESHIRE EAST BOROUGH COUNCIL  
(A500 DUALLING)  
COMPULSORY PURCHASE ORDER  
PLAN 2020

LAND AT DAISY BANK  
FARM, SMITHY LANE AND  
OTHER ALTERATIONS  
SITE PLAN NO. 4



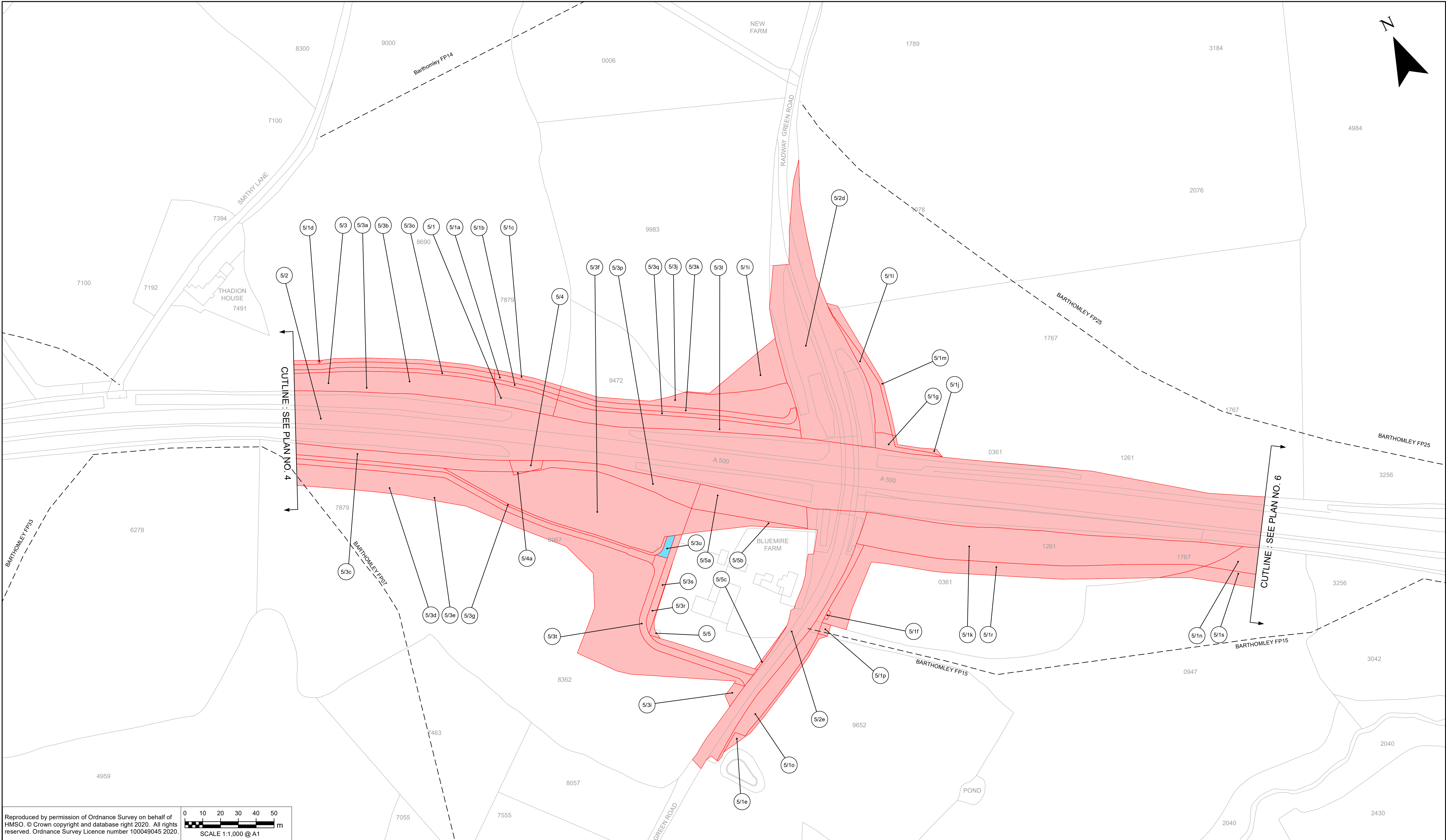

Reproduced by permission of Ordnance Survey on behalf of HMSO. © Crown copyright and database right 2020. All rights reserved. Ordnance Survey Licence number 100049045 2020.

0 10 20 30 40 50 m  
SCALE 1:1,000 @ A1

**NOTES:**

- Order under sections 8, 239, 240, 246, 250 and 260 of the Highways Act 1980.
- This plan does not show widths or construction details.

**KEY**

- Title
- S250 Right
- Local authority boundary
- Parish boundary
- Public right of way
- 0038 Ordnance Survey field numbers

The Common Seal of  
CHESHIRE EAST BOROUGH COUNCIL  
was hereunto affixed in the presence of

Dated this                  day of                  2020



**Cheshire East**  
Council

Drawing No.	BRJ10412-CPO-005	Revision	0
-------------	------------------	----------	---

CHESHIRE EAST BOROUGH COUNCIL  
(A500 DUALLING)  
COMPULSORY PURCHASE ORDER  
PLAN 2020

BLUEMIRE FARM,  
RADWAY GREEN ROAD  
AND OTHER ALTERATIONS  
SITE PLAN NO. 5



