

PROPOSED BASEMENT PLAN

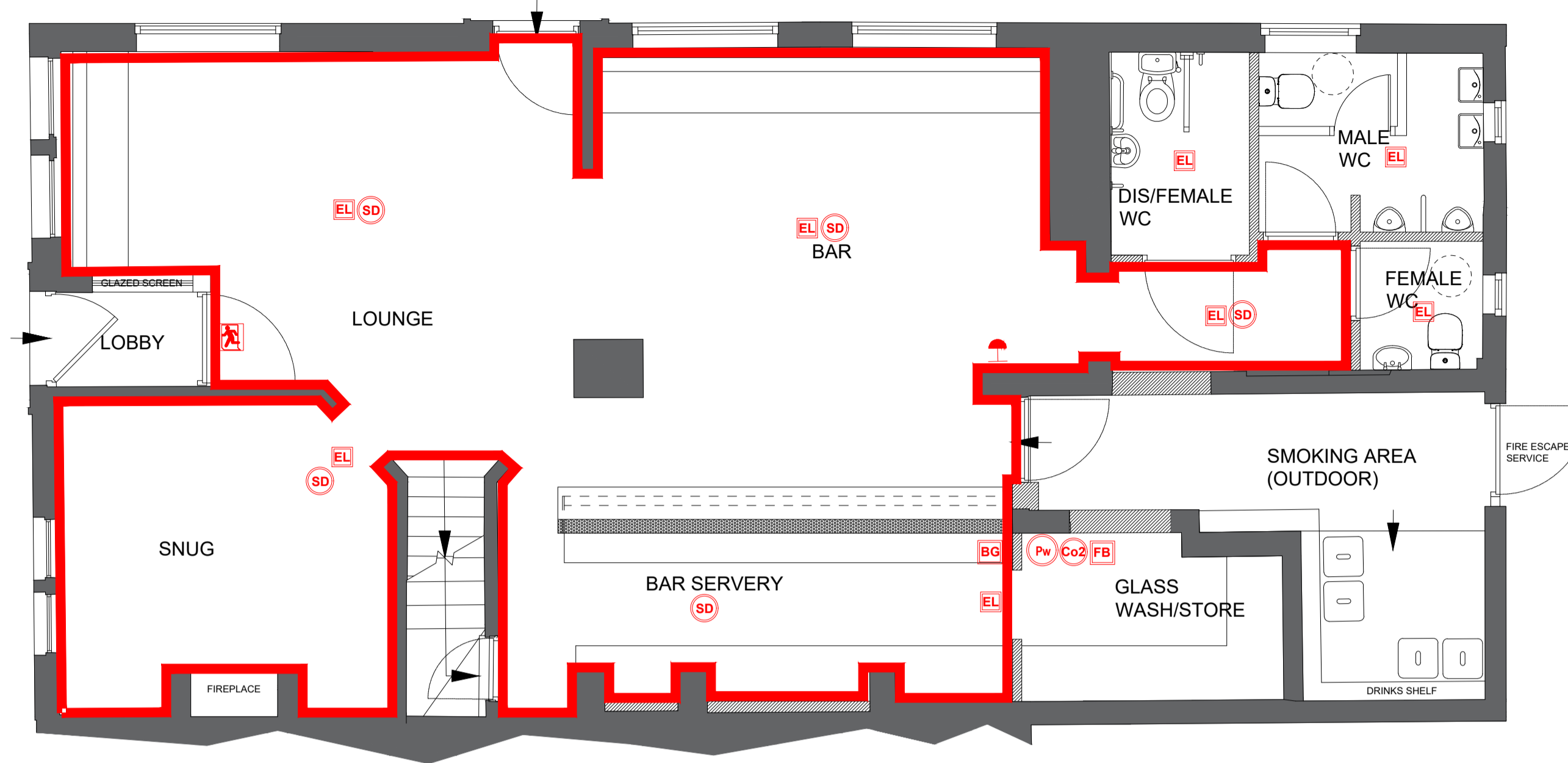

PROPOSED GROUND FLOOR PLAN

LICENSING NOTES

Items shown on this plan which are not required by the Plans Regulations are for illustrative purposes only and do not form part of the license. These items may be moved at the discretion of the License Holder. The current location of the fire safety equipment and other safety equipment is as shown. The items may be moved from time to time with agreement of the Fire Officer or after fire risk assessment.

Areas for licensable activities:



LICENSING LEGEND

- EL Area covered by non maintained emergency light.
- SD Area covered by heat/smoke detector.
- BG Break glass point.
- PB Push bar fastening to door.
- VP Vision panel.
- EXIT Internally illuminated 'fire exit' sign.
- RMS Internally illuminated running man sign.
- FA Fire alarm sounder.
- VWD Visual Warning Device
- CO2 Fire extinguisher: co2.
- W Fire extinguisher: water.
- PW Fire extinguisher: powder.
- FB Fire blanket.

All extinguishers are to comply with the current BS EN3 standard. New alarm & break glass points complete located as shown on plan.



PROPOSED FIRST FLOOR PLAN

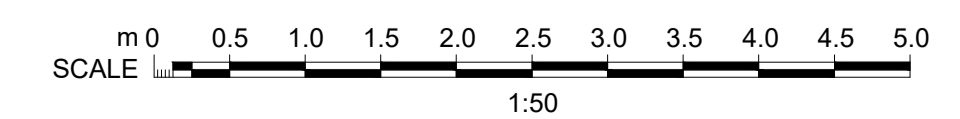

Client NICK WHITBY	
Date	SEPT 23
Drawn	RR
Scale	1:50
Size	A1
Rev.	Drawing No. W&C - L-01
Drawing Title Proposed Licensing	
Project Title Welles & Cross 17 Welles St, Sandbach CW11 1GT	