

**Application for a premises licence to be granted
under the Licensing Act 2003**

PLEASE READ THE FOLLOWING INSTRUCTIONS FIRST

Before completing this form please read the guidance notes at the end of the form. If you are completing this form by hand please write legibly in block capitals. In all cases ensure that your answers are inside the boxes and written in black ink. Use additional sheets if necessary.

You may wish to keep a copy of the completed form for your records.

I/We Rajenthiran Selliah

(Insert name(s) of applicant)

apply for a premises licence under section 17 of the Licensing Act 2003 for the premises described in Part 1 below (the premises) and I/we are making this application to you as the relevant licensing authority in accordance with section 12 of the Licensing Act 2003

Part 1 – Premises Details

Postal address of premises or, if none, ordnance survey map reference or description Park News 71-73 Brown Street			
Post town	Macclesfield	Postcode	SK11 6RY
Telephone number at premises (if any)			
Non-domestic rateable value of premises		£ 2650	

Part 2 - Applicant Details

Please state whether you are applying for a premises licence as

Please tick as appropriate

- | | | |
|---|-------------------------------------|-----------------------------|
| a) an individual or individuals * | <input checked="" type="checkbox"/> | please complete section (A) |
| b) a person other than an individual * | | |
| i. as a limited company | | please complete section (B) |
| ii. as a partnership | <input type="checkbox"/> | please complete section (B) |
| iii. as an unincorporated association or | <input type="checkbox"/> | please complete section (B) |
| iv. other (for example a statutory corporation) | <input type="checkbox"/> | please complete section (B) |
| c) a recognised club | <input type="checkbox"/> | please complete section (B) |
| d) a charity | <input type="checkbox"/> | please complete section (B) |

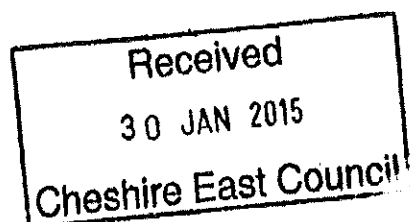

- e) the proprietor of an educational establishment ☐ please complete section (B)
- f) a health service body ☐ please complete section (B)
- g) a person who is registered under Part 2 of the Care Standards Act 2000 (c14) in respect of an independent hospital in Wales ☐ please complete section (B)
- ga) a person who is registered under Chapter 2 of Part 1 of the Health and Social Care Act 2008 (within the meaning of that Part) in an independent hospital in England ☐ please complete section (B)
- h) the chief officer of police of a police force in England and Wales ☐ please complete section (B)

* If you are applying as a person described in (a) or (b) please confirm:

Please tick yes

I am carrying on or proposing to carry on a business which involves the use of the premises for licensable activities; or ☒

I am making the application pursuant to a
 statutory function or ☐
 a function discharged by virtue of Her Majesty's prerogative ☐

(A) INDIVIDUAL APPLICANTS (fill in as applicable)

Mr <input checked="" type="checkbox"/>	Mrs	Miss <input type="checkbox"/>	Ms <input type="checkbox"/>	Other Title (for example, Rev)	
Surname Selliah			First names Rajenthiran		
I am 18 years old or over			Please tick yes <input checked="" type="checkbox"/>		
Current postal address if different from premises address		1-2 Wallbridge Precinct			
Post town	Leek			Postcode	ST13 8JF
Daytime contact telephone number		01432 31992			
E-mail address (optional)					

SECOND INDIVIDUAL APPLICANT (if applicable)

Mr	Mrs	Miss <input type="checkbox"/>	Ms <input type="checkbox"/>	Other Title (for example, Rev)	
Surname			First names		
I am 18 years old or over				Please tick yes X	
Current postal address if different from premises address					
Post town				Postcode	
Daytime contact telephone number					
E-mail address (optional)					

(B) OTHER APPLICANTS

Please provide name and registered address of applicant in full. Where appropriate please give any registered number. In the case of a partnership or other joint venture (other than a body corporate), please give the name and address of each party concerned.

Name
Address
Registered number (where applicable)
Description of applicant (for example, partnership, company, unincorporated association etc.)
Telephone number (if any)
E-mail address (optional)

Part 3 Operating Schedule

When do you want the premises licence to start?

DD	MM	YYYY
<input type="text"/>	<input type="text"/>	<input type="text"/>

If you wish the licence to be valid only for a limited period, when do you want it to end?

DD	MM	YYYY
<input type="text"/>	<input type="text"/>	<input type="text"/>

Please give a general description of the premises (please read guidance note 1)
A small convenience store

If 5,000 or more people are expected to attend the premises at any one time, please state the number expected to attend.

What licensable activities do you intend to carry on from the premises?

(Please see sections 1 and 14 of the Licensing Act 2003 and Schedules 1 and 2 to the Licensing Act 2003)

Provision of regulated entertainment

Please tick any that apply

- a) plays (if ticking yes, fill in box A)
- b) films (if ticking yes, fill in box B)
- c) indoor sporting events (if ticking yes, fill in box C)
- d) boxing or wrestling entertainment (if ticking yes, fill in box D) ☐
- e) live music (if ticking yes, fill in box E)
- f) recorded music (if ticking yes, fill in box F)
- g) performances of dance (if ticking yes, fill in box G) ☐
- h) anything of a similar description to that falling within (e), (f) or (g) (if ticking yes, fill in box H) ☐

Provision of late night refreshment (if ticking yes, fill in box I)

Supply of alcohol (if ticking yes, fill in box J)

X

In all cases complete boxes K, L and M

A

Plays Standard days and timings (please read guidance note 6)			<u>Will the performance of a play take place indoors or outdoors or both – please tick</u> (please read guidance note 2)	Indoors	<input type="checkbox"/>
				Outdoors	<input type="checkbox"/>
				Both	<input type="checkbox"/>
Day	Start	Finish			
Mon			<u>Please give further details here</u> (please read guidance note 3)		
Tue					
Wed			<u>State any seasonal variations for performing plays</u> (please read guidance note 4)		
Thur					
Fri			<u>Non standard timings. Where you intend to use the premises for the performance of plays at different times to those listed in the column on the left, please list</u> (please read guidance note 5)		
Sat					
Sun					

B

Films Standard days and timings (please read guidance note 6)			Will the exhibition of films take place indoors or outdoors or both – please tick (please read guidance note 2)		Indoors	
					Outdoors	<input type="checkbox"/>
					Both	<input type="checkbox"/>
Day	Start	Finish	Please give further details here (please read guidance note 3)			
Mon						
Tue						
Wed			State any seasonal variations for the exhibition of films (please read guidance note 4)			
Thur						
Fri						
Sat			Non standard timings. Where you intend to use the premises for the exhibition of films at different times to those listed in the column on the left, please list (please read guidance note 5) As section J			
Sun						

C

Indoor sporting events Standard days and timings (please read guidance note 6)			Please give further details (please read guidance note 3)
Day	Start	Finish	
Mon			
Tue			State any seasonal variations for indoor sporting events (please read guidance note 4)
Wed			
Thur			Non standard timings. Where you intend to use the premises for indoor sporting events at different times to those listed in the column on the left, please list (please read guidance note 5)
Fri			
Sat			
Sun			

D

Boxing or wrestling entertainments Standard days and timings (please read guidance note 6)			Will the boxing or wrestling entertainment take place indoors or outdoors or both – please tick (please read guidance note 2)	Indoors	<input type="checkbox"/>
				Outdoors	<input type="checkbox"/>
				Both	<input type="checkbox"/>
Day	Start	Finish	Please give further details here (please read guidance note 3)		
Mon					
Tue					
Wed			State any seasonal variations for boxing or wrestling entertainment (please read guidance note 4)		
Thur					
Fri					
Sat			Non standard timings. Where you intend to use the premises for boxing or wrestling entertainment at different times to those listed in the column on the left, please list (please read guidance note 5)		
Sun					

E

Live music Standard days and timings (please read guidance note 6)			Will the performance of live music take place indoors or outdoors or both – please tick (please read guidance note 2)	Indoors	<input type="checkbox"/>
				Outdoors	<input type="checkbox"/>
				Both	<input type="checkbox"/>
Day	Start	Finish	Please give further details here (please read guidance note 3)		
Mon					
Tue					
			State any seasonal variations for the performance of live music (please read guidance note 4)		
Wed					
Thur					
			Non standard timings. Where you intend to use the premises for the performance of live music at different times to those listed in the column on the left, please list (please read guidance note 5)		
Fri					
Sat					
Sun					

F

Recorded music Standard days and timings (please read guidance note 6)			Will the playing of recorded music take place indoors or outdoors or both – please tick (please read guidance note 2)	Indoors	<input type="checkbox"/>
				Outdoors	<input type="checkbox"/>
				Both	<input type="checkbox"/>
Day	Start	Finish	Please give further details here (please read guidance note 3)		
Mon					
Tue					
Wed			State any seasonal variations for the playing of recorded music (please read guidance note 4)		
Thur					
Fri			Non standard timings. Where you intend to use the premises for the playing of recorded music at different times to those listed in the column on the left, please list (please read guidance note 5)		
Sat					
Sun					

G

Performances of dance Standard days and timings (please read guidance note 6)			<u>Will the performance of dance take place indoors or outdoors or both – please tick (please read guidance note 2)</u>		Indoors	<input type="checkbox"/>
					Outdoors	<input type="checkbox"/>
					Both	<input type="checkbox"/>
Day	Start	Finish	<u>Please give further details here (please read guidance note 3)</u>			
Mon						
Tue						
			<u>State any seasonal variations for the performance of dance (please read guidance note 4)</u>			
Wed						
Thur						
			<u>Non standard timings. Where you intend to use the premises for the performance of dance at different times to those listed in the column on the left, please list (please read guidance note 5)</u>			
Fri						
Sat						
Sun						

H

Anything of a similar description to that falling within (e), (f) or (g) Standard days and timings (please read guidance note 6)			Please give a description of the type of entertainment you will be providing		
Day	Start	Finish	<u>Will this entertainment take place indoors or outdoors or both – please tick</u> (please read guidance note 2)	Indoors	<input type="checkbox"/>
Mon				Outdoors	<input type="checkbox"/>
				Both	<input type="checkbox"/>
Tue			<u>Please give further details here</u> (please read guidance note 3)		
Wed					
Thur			<u>State any seasonal variations for entertainment of a similar description to that falling within (e), (f) or (g)</u> (please read guidance note 4)		
Fri					
Sat			<u>Non standard timings. Where you intend to use the premises for the entertainment of a similar description to that falling within (e), (f) or (g) at different times to those listed in the column on the left, please list</u> (please read guidance note 5)		
Sun					

I

Late night refreshment Standard days and timings (please read guidance note 6)			Will the provision of late night refreshment take place indoors or outdoors or both – please tick (please read guidance note 2)	Indoors	<input type="checkbox"/>
				Outdoors	<input type="checkbox"/>
				Both	<input type="checkbox"/>
Day	Start	Finish	Please give further details here (please read guidance note 3)		
Mon					
Tue					
			State any seasonal variations for the provision of late night refreshment (please read guidance note 4)		
Wed					
Thur					
			Non standard timings. Where you intend to use the premises for the provision of late night refreshment at different times, to those listed in the column on the left, please list (please read guidance note 5)		
Fri					
Sat					
Sun					

J

Supply of alcohol Standard days and timings (please read guidance note 6)			Will the supply of alcohol be for consumption – please tick (please read guidance note 7)	On the premises		
				Off the premises	X	
				Both		
Day	Start	Finish	State any seasonal variations for the supply of alcohol (please read guidance note 4)			
Mon	08.00	22.00				
Tue	08.00	22.00				
Wed	08.00	22.00				
Thur	08.00	22.00				Non standard timings. Where you intend to use the premises for the supply of alcohol at different times to those listed in the column on the left, please list (please read guidance note 5)
Fri	08.00	22.00				
Sat	08.00	22.00				
Sun	08.00	22.00				

State the name and details of the individual whom you wish to specify on the licence as designated premises supervisor:

Name Rajenthiran Selliah	
Address 1-2 Wallbridge Precinct Leek	
Postcode	ST13 8JF
Personal licence number (if known)	
Issuing licensing authority (if known) Cheshire East Council	

K

Please highlight any adult entertainment or services, activities, other entertainment or matters ancillary to the use of the premises that may give rise to concern in respect of children (please read guidance note 8).

L

Hours premises are open to the public Standard days and timings (please read guidance note 6)			State any seasonal variations (please read guidance note 4)
Day	Start	Finish	
Mon	06.00	22.00	
Tue	06.00	22.00	
Wed	06.00	22.00	
Thur	06.00	22.00	
Fri	06.00	22.00	Non standard timings. Where you intend the premises to be open to the public at different times from those listed in the column on the left, please list (please read guidance note 5)
Sat	06.00	22.00	
Sun	06.00	22.00	

M Describe the steps you intend to take to promote the four licensing objectives:

a) General – all four licensing objectives (b, c, d and e) (please read guidance note 9)

The following steps have been identified by risk assessment in relation to the four licensing objectives

We have also considered the terms of your local licensing policy in preparing this application

b) The prevention of crime and disorder

CCTV must be installed and operative to the approval of the Police Licensing Office (PLO). The CCTV unit shall be positioned in a secure part of the licensed premise and not within any private area of the location.

The CCTV must be maintained so as to be fully operational and recording at all times when the premises are open to the public

All images should be kept for a 28 day period and to be produced to the Police, Trading Standards or Local Authority Officers, upon request or within 24 hours of such a request.

There will be notices displayed throughout the premises stating that CCTV is in operation.

The CCTV system clock should be set correctly and maintained (taking account of GMT and BST).

Weekly checks to be made to check the operation of the CCTV system and confirm it is working correctly and such checks to be recorded in a register which is to be endorsed by the person conducting the check and to contain the name of the person conducting the check, and this record is to be kept fully updated at all times and remain on the premises for immediate inspection by the Police, Trading Standards or Local Authority Licensing Officers upon request

The premise will not undertake or participate in any form of alcohol delivery to a person's home address or place of work.

c) Public safety

Any gas and electrical appliances on the premises will have current safety certificates

The Designated Premises Supervisor shall ensure that a written log of any accident or incidents is kept on the premises with all the details recorded of dates, times incident and staff involved etc.

Adequate and appropriate first aid equipment will be available

Fire extinguishers to be regularly checked

Fire risk assessment to be completed and made available for inspection by an authorised officer of Cheshire Fire & Rescue Service

d) The prevention of public nuisance

Notices to be displayed requesting patrons to disperse quietly from the premises

Regular checks by staff of the immediate outside area and to encourage patrons to conduct themselves in an orderly manner

To encourage persons to use the litter and conduct a daily litter sweep

e) The protection of children from harm

The premises will adopt a locally recognised Challenge 25 scheme to tackle underage sales.

All staff will be fully trained in its use before being allowed to sell alcohol. This training to be refreshed every 2 calendar months and a written record kept .

Persons who appear to be under the age of 25 shall be required to produce proof of age by way of a proof of age card accredited under the Proof of Age Standard Scheme (PASS). The only acceptable alternative being either a photo driving licence or passport.

The Designated Premises Supervisor should ensure that a record is kept of all staff training and is fully updated at all times. The records of training must be kept at the licensed premises and be made available immediately to police officer or trading standard officers upon request.

A refusals book must be held at the premises and contain details of the time and date of any sales refused in relation to persons that are under age. The book must also contain details of the staff member refusing the sale. The DPS will check the book on a monthly basis and endorse the book with the time and date of inspection.

All persons authorised to sell alcohol will complete an underage sales training programme which includes a written test to verify his or her competency. This record will be available to the Police or authorised officers of Cheshire East Council

A written record (which shall be immediately available for inspection by Police officers or authorised officers authorised by Cheshire East Council shall be kept at the premises of all persons who are authorised to sell alcohol

Checklist:

Please tick to indicate agreement

- | | |
|--|---|
| • I have made or enclosed payment of the fee. | X |
| • I have enclosed the plan of the premises. | X |
| • I have sent copies of this application and the plan to responsible authorities and others where applicable. | X |
| • I have enclosed the consent form completed by the individual I wish to be designated premises supervisor, if applicable. | X |
| • I understand that I must now advertise my application. | X |
| • I understand that if I do not comply with the above requirements my application will be rejected. | X |

IT IS AN OFFENCE, LIABLE ON SUMMARY CONVICTION TO A FINE NOT EXCEEDING LEVEL 5 ON THE STANDARD SCALE, UNDER SECTION 158 OF THE LICENSING ACT 2003, TO MAKE A FALSE STATEMENT IN OR IN CONNECTION WITH THIS APPLICATION.

Part 4 – Signatures (please read guidance note 10)

**Signature of applicant or applicant's solicitor or other duly authorised agent (see guidance note 11).
If signing on behalf of the applicant, please state in what capacity.**

Signature	
Date	
Capacity	Licensing Agent

For joint applications, signature of 2nd applicant or 2nd applicant's solicitor or other authorised agent (please read guidance note 12). If signing on behalf of the applicant, please state in what capacity.

Signature	
Date	
Capacity	

Contact name (where not previously given) and postal address for correspondence associated with this application (please read guidance note 13)

Trent Licensing
223 New Inn Lane
Trentham

Post town	Stoke on Trent	Postcode	ST4 8PS
-----------	----------------	----------	---------

Telephone number (if any)	01827 205000
---------------------------	-------------------------

If you would prefer us to correspond with you by e-mail, your e-mail address (optional)

PAAR NEWS
71-73 BROWN STREET
MACCLESFIELD

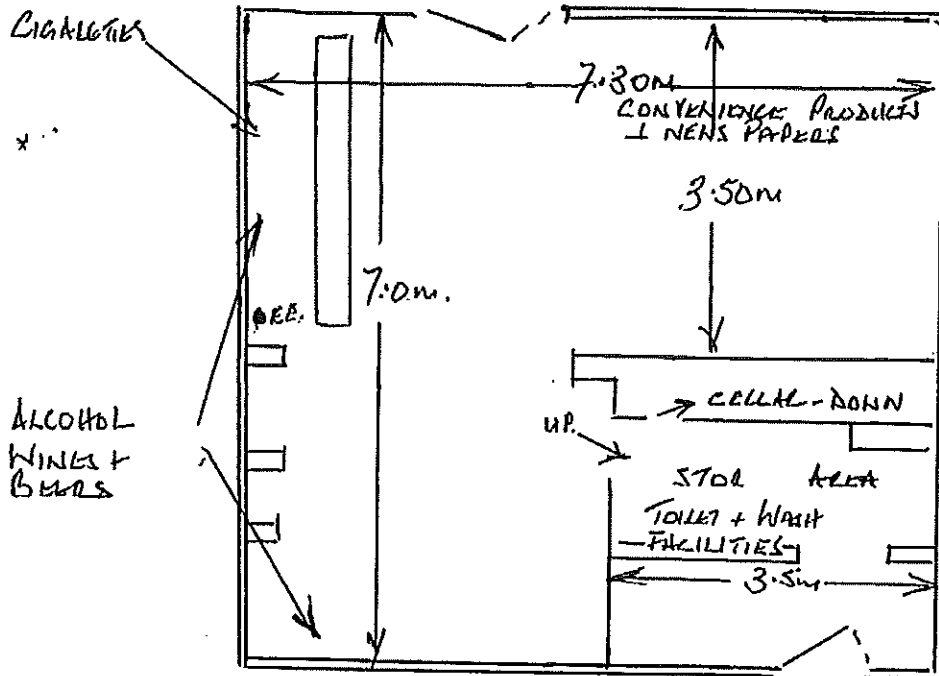

• FIRE - FIRE EXTINGUISHER

NOT TO SCALE

The Licensing Section
Cheshire East Council
Municipal Buildings
Earle Street
Crewe, CW1 2BJ.

Dear Sirs,

Application for a Premises Licence by:
Park News, 71-73 Brown Street, Macclesfield SK11 6RY

I am writing to register my objection to the application for a premises licence by
Rajenthiran Selliah for a Premises Licence at:
Park News, 71-73 Brown Street, Macclesfield SK11 6RY.

The basis for this opposition is that granting a licence for these premises will not promote the licensing objectives, particularly the prevention of crime, disorder and antisocial behaviour.

71-73 Brown Street, Macclesfield, lies in a overwhelmingly residential area and enabling the premises to sell alcohol would be totally detrimental to this area.

The application proposes that alcohol will be sold for consumption off the premises between 0800 hours and 2200 hours, seven days a week.

Granting a licence would provide a further source of alcohol within an area already heavily populated with licensed premises. There are four public houses within 250 metres of the site and an existing off-licence within 50 metres of the proposed site.

Taking account of the planned opening hours I am concerned that the granting of this licence will:
create a public nuisance
potentially lead to crime and disorder
will encourage young visitors to the nearby park to purchase alcohol for consumption in there.

Residents in this area already suffer an element of noise, nuisance and antisocial behaviour and granting of a licence can only exacerbate these problems.

I respectfully ask the licensing committee to refuse this application.

Yours faithfully,

CROWN LIQUOR STORE

60 Brown Street

Macclesfield

SK11 6RY

Telephone 01625 421

Received

18 FEB 2015

Cheshire East Council

6 February 2015

Dear Neighbour

We are writing to you with regard to the Park News at 71-73 Brown Street.

An application has been submitted, by the potential owner/tenant Mr Rajenthiran Selliah, to Cheshire East Council for a Premises Licence to sell alcohol from 8.00 am until 10.00 pm – seven days a week.

As a local resident you will be aware that we have purposely regulated our opening hours to reduce the impact of our business to the absolute minimum.

We obviously have a vested interest but, as residents ourselves, are genuinely concerned about the impact an 'open all hours' store selling alcohol would have on our local community.

In anticipation of you sharing our concerns, we are enclosing a template letter of objection.

If you wish to use that letter, please add your address details at the top right of the letter, sign the letter, then post it in the enclosed stamped and addressed envelope to The Licensing Section, Cheshire East Council, Municipal Buildings, Earle Street, Crewe, CW1 2BJ.

Alternatively, you may wish to write a letter of your own. But note that for objections to be considered they must relate to: crime, anti-social behaviour, nuisance or a negative impact on the local community.

Yours faithfully,

PS. No SAK enclosed with your letters

(147)

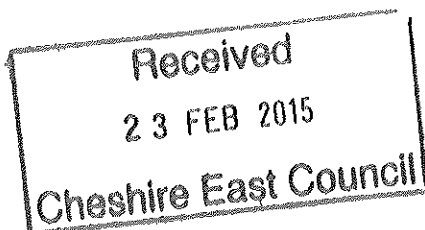

18 February 2015

The Licensing Section
Cheshire East Council
Municipal Buildings
Earle Street
Crewe
CW1 2BJ

Dear Sirs

Application for a Premises Licence by:
Park News, 71-73 Brown Street, Macclesfield SK11 6RY

I am writing to register my objection to the application for a premises licence by Rajenthiran Selliah for a Premises Licence at: Park News, 71-73 Brown Street, Macclesfield SK11 6RY

The reason for this opposition is that granting a licence for these premises will not promote the licensing objectives, particularly prevention of crime, disorder and antisocial behaviour.

71-73 Brown Street, Macclesfield sits opposite our property in an overwhelmingly residential area and enabling the premises to sell alcohol would be totally detrimental to this area.

The application proposes that alcohol will be sold for consumption off the premises between 0800 hours and 2200 hours, seven days a week.

Granting a licence would provide a further source of alcohol within an area already heavily populated with licensed premises. There are four public houses within 250 metres of the site and an existing off-licence within 50 metres of the proposed site.

Taking account of the planned opening hours, I am concerned that the granting of this licence will: create public nuisance, potentially lead to crime and disorder, will encourage young visitors to the nearby park to purchase alcohol for consumption in there.

As residents in this area we already suffer an element of noise, nuisance and antisocial behaviour and granting a licence can only exacerbate these problems.

For years we have had to deal with the consequences of living so close to licensed premises. It is not unusual to find evidence of urination up against our property and also the disposal of empty beer bottles or cans, left on our doorstep or windowsill. Living in an end-terraced property, on a corner, we often experience youths loitering outside of our front door, waiting for 'friends' to purchase their alcohol. I can only imagine this will get worse if another licensed premises opens directly opposite our house.

I respectfully ask the licensing committee to refuse this application.

Yours faithfully

J

The Licensing Section
Cheshire East Council
Municipal Buildings
Earle Street
Crewe
CW1 2BJ

2/3/2015

**Re Application for the Sale of Alcohol at 71-73 Brown Street, Macclesfield,
SK11 6RY**

Dear Sirs

I am writing to register my objection the above application for a License to sell Alcohol on these premises.

Given the location of the premises and the close proximity of the Macclesfield Learning Zone, there are inevitably a large percentage of young people within this immediate area during the proposed hours of opening. The availability of Alcohol at 8.00am, 7 days a week, In my opinion is creating more opportunity for underage drinking, anti-social behaviour etc. Given that there is already an off license immediately opposite this proposed site, which controls its alcohol sales hours responsibly, how many outlets does one street need.

I hope that you will give due consideration to my objection to this application,

Yours Sincerely

The Licensing Section
Cheshire East Council
Municipal Buildings
Earle Street
Crewe
CW1 2BJ

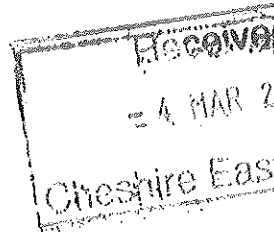

Dear Sirs

Application for a Premises Licence by:
Park News, 71-73 Brown Street, Macclesfield SK11 6RY

I am writing to register my objection to the application for a premises licence by Rajenthiran Selliah at Park News, 71-73 Brown Street, Macclesfield SK11 6RY.

The basis for this opposition is that granting a licence for these premises will not promote the licensing objectives, particularly the prevention of crime, disorder and antisocial behaviour.

71-73 Brown Street, Macclesfield, lies in an overwhelmingly residential area and enabling the premises to sell alcohol would be totally detrimental to the area.

The application proposes that alcohol will be sold for consumption off the premises between 0800 hours and 2200 hours, seven days a week. Granting this licence would provide a further source of alcohol within an area already heavily populated with licensed premises. There are four public houses within 250 metres of the site, one existing off-licence within 50 metres and 2 others within 400 metres on Bond Street and Park Lane.

Taking into account the planned opening hours, I am concerned that the granting of this licence will:

create a public nuisance. Litter on the streets is a growing problem and in this locality the problem is intensified in areas adjacent to such premises. Not only are bottles and broken glass unsightly, but they are dangerous too, both to humans and animals;

potentially lead to crime and disorder. These premises have in the past been the target of street robbers, the last attack being of a particularly unpleasant nature. The employee who was the victim of the attack was so badly affected that she was unable to continue to work there again. The opening hours proposed will merely widen the window for such opportunistic attacks;

will encourage young visitors to walk to the nearby park to consume alcohol purchased on the premises. Groups of people congregating in Band Stand area, for example, to consume purchases bought would be a detrimental outcome.

Residents in this area already suffer an element of noise, nuisance and antisocial behaviour and the granting of a licence can only exacerbate these problems.

I respectfully ask the licensing committee to refuse this application.

The Licensing Section
Cheshire East Council
Municipal Buildings
Earle Street
Crewe, CW1 2BJ.

Dear Sirs,

Application for a Premises Licence by:
Park News, 71-73 Brown Street, Macclesfield SK11 6RY

I am writing to register my objection to the application for a premises licence by
Rajenthiran Selliah for a Premises Licence at:
Park News, 71-73 Brown Street, Macclesfield SK11 6RY.

The basis for this opposition is that granting a licence for these premises will not promote the licensing objectives, particularly the prevention of crime, disorder and antisocial behaviour.

71-73 Brown Street, Macclesfield, lies in a overwhelmingly residential area and enabling the premises to sell alcohol would be totally detrimental to this area.

The application proposes that alcohol will be sold for consumption off the premises between 0800 hours and 2200 hours, seven days a week.

Granting a licence would provide a further source of alcohol within an area already heavily populated with licensed premises. There are four public houses within 250 metres of the site and an existing off-licence within 50 metres of the proposed site.

Taking account of the planned opening hours I am concerned that the granting of this licence will:

create a public nuisance

potentially lead to crime and disorder

will encourage young visitors to the nearby park to purchase alcohol for consumption in there.

Residents in this area already suffer an element of noise, nuisance and antisocial behaviour and granting of a licence can only exacerbate these problems.

I respectfully ask the licensing committee to refuse this application.

Yours faithfully,

~~LCS~~ ~~PREM~~ ~~CO~~ ^{LCPREM CO} I would suggest this is vexatious on the rounds of ✓ and irrelevant. It has been put through competition

CROWN LIQUOR STORE

the doors of a hugely wide radius

60 Brown Street
Macclesfield
SK11 6RY
Telephone 01625 426606

6 February 2015

Dear Neighbour

We are writing to you with regard to the Park News at 71-73 Brown Street.

An application has been submitted, by the potential owner/tenant Mr Rajenthiran Selliah, to Cheshire East Council for a Premises Licence to sell alcohol from 8.00 am until 10.00 pm – seven days a week.

As a local resident you will be aware that we have purposely regulated our opening hours to reduce the impact of our business to the absolute minimum.

We obviously have a vested interest but, as residents ourselves, are genuinely concerned about the impact an 'open all hours' store selling alcohol would have on our local community.

In anticipation of you sharing our concerns, we are enclosing a template letter of objection.

If you wish to use that letter, please add your address details at the top right of the letter, sign the letter, then post it in the enclosed stamped and addressed envelope to The Licensing Section, Cheshire East Council, Municipal Buildings, Earle Street, Crewe, CW1 2BJ.

Alternatively, you may wish to write a letter of your own. But note that for objections to be considered they must relate to: crime, anti-social behaviour, nuisance or a negative impact on the local community.

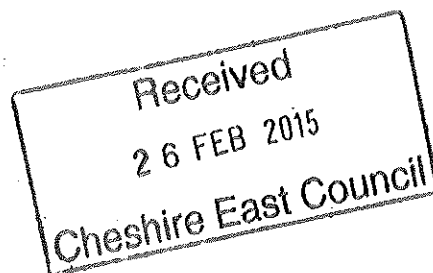

Cheshire CC WebGIS

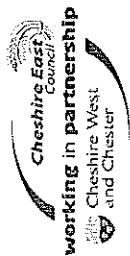

(c) Crown copyright and database rights 2015. Ordnance Survey 100049045.
100049046.

